

American Safe Room, Inc.

Hospital and Industrial **Iso-Shield 800**

**Dual use, dual mounting options:
Isolation room—negative pressure
Clean room—positive pressure**

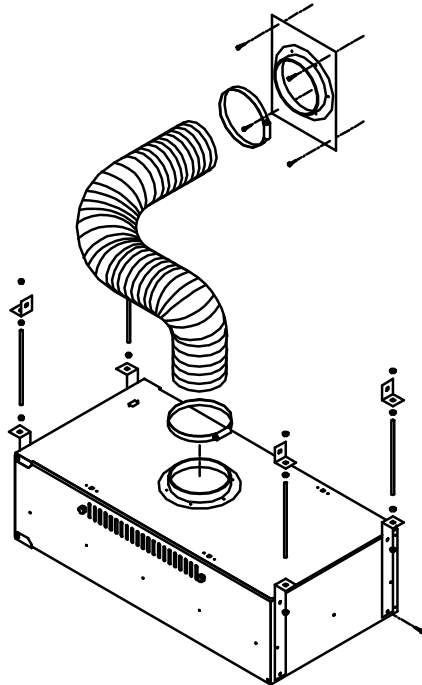

**Permanent horizontal
ceiling mount**

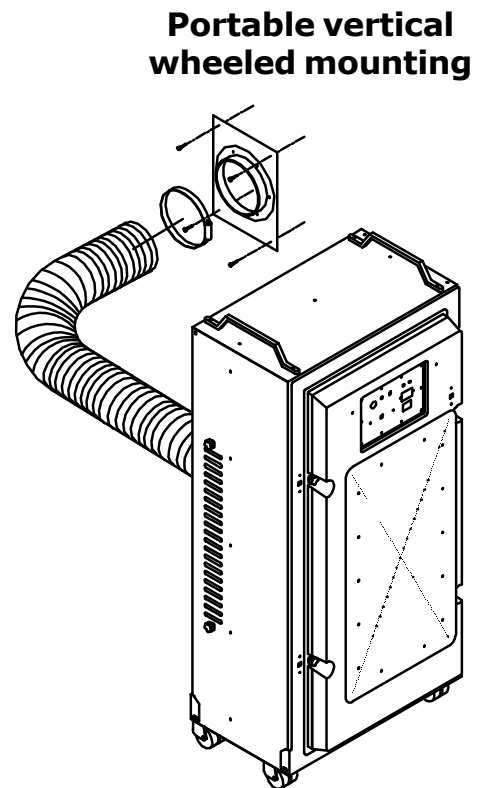

**Portable vertical
wheeled mounting**

**Installation and Operations Manual
Description, Specifications, and Parts**

**Revision D
June 7, 2007**

Table of Contents

General description	3
Specifications	4
Controls	5
Negative pressure conversion kit	6
Permanent ceiling installation	7
Changing the pre-filter and UV lamps	8
Changing the HEPA filter	9

General Description

The Iso-Shield 800 is a medical grade, portable air purifying system using HEPA filtration and optionally complemented by ultraviolet germicidal radiation.

It is designed to operate in a fluid hospital or industrial environment where positive or negative air pressure is needed without delay. It can be stored with the optional castor wheels in place to be rapidly deployed when needed. The advantage this gives is flexibility. Isolation rooms can quickly and securely be made out of ordinary hospital rooms by wheeling the Iso-Shield 800 into the room. If more isolation rooms are needed on a permanent or semipermanent basis, this same Iso-Shield 800 can be mounted into the framework of a false ceiling and plumbed into the existing HVAC system.

Additionally the Iso-Shield 800 is capable of functioning in a air recirculation mode or in a non-recirculation mode for negative pressure isolation rooms. The amount of air that is recirculated is easily and infinitely adjustable by a vent on the side of the filter housing.

The Iso-Shield 800 is in compliance with applicable OSHA, CDC, JCHO requirements, guidelines, standards and/or recommendations.

Specifications

- Size:** Height: 47.75 inches, width: 23.75 inches, depth: 19.75 inches
Weight: 130 pounds
Output: Infinitely adjustable between 200 to 860 cubic feet per minute
Please note: this is true system airflow output incorporating filter resistance, not just what the blower is rated for
- Blower specs:** Dual 610 CFM motorized impellers
Noise level: 60 dBA at typical distance from bed to footwall or ceiling
Voltage: 120-240 volts/50-60 hertz
Power consumption: 460 watts
Cabinet: Hospital grade brushed and polished stainless steel and ABS plastic
Mounting: Portability enhanced by integral caster wheels
Designed and built within the envelope necessary to be ceiling mounted in a 24 x 48 inch typical false ceiling
- Lubrication:** Permanent sealed lubrication on all moving parts
Filters: Antimicrobial pre-filter rated for 30% ASHARE
HEPA 99.97% at 0.3 microns—scan tested and certified
UV Lamps: Optional UVC lamps—minimum of 12,000 u Watt/sec/cm²

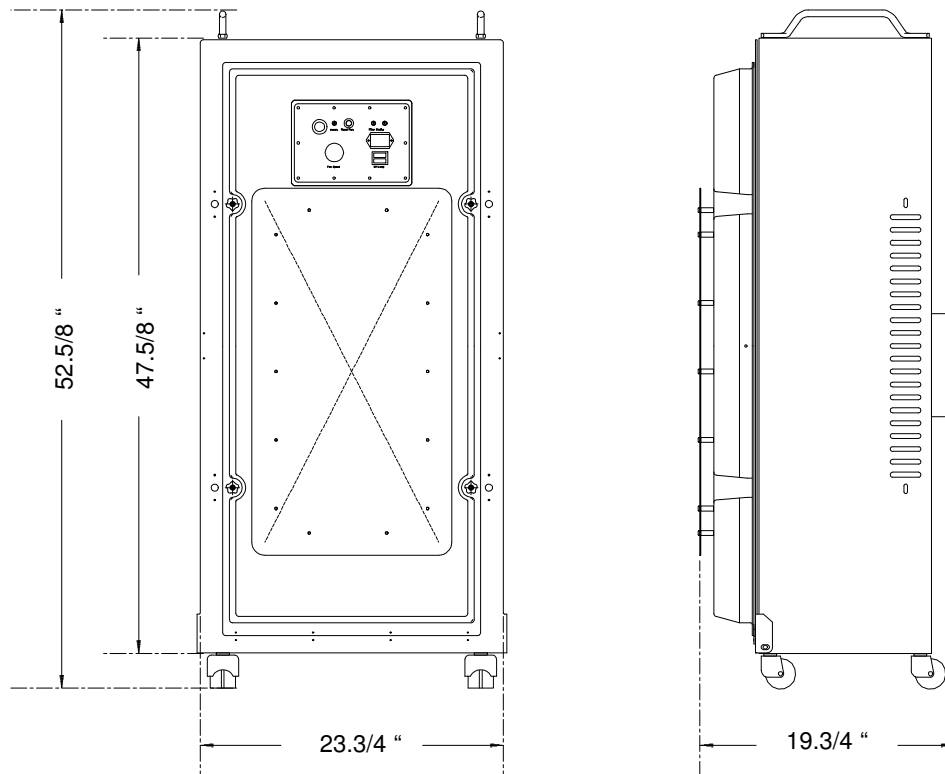

Controls

Legend

- A — Key lock power switch
- B — Blower control, variable
- C — Power on pilot lamp (green)
- D — Mini circuit breaker, push button
- E — Hour meter
- F — Lighted switch, UV lights (green)
- G — Clean filter safety lamp (green)
- H — Dirty filter warning lamp (red)
- I — Recirculating vents open/close or adjust airflow

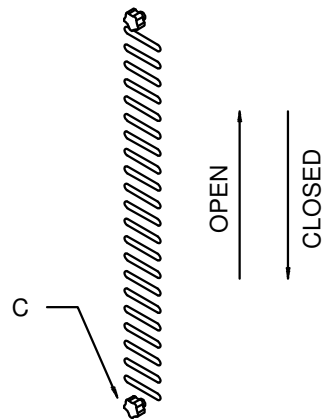
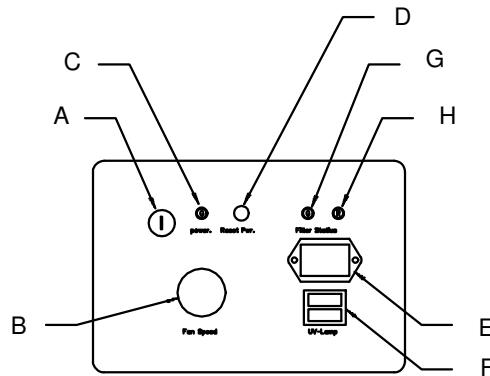
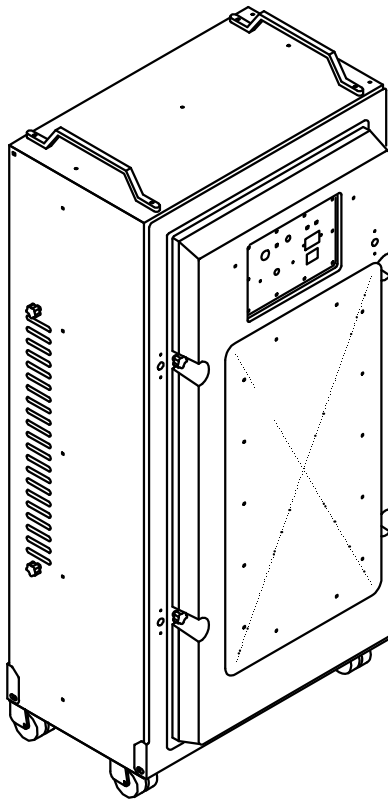

Negative Pressure Conversion Kit

The Iso-Shield 800 in conjunction with the provided duct connection kit is capable of rapidly transforming a conventional hospital emergency department treatment room (or other similar sized room) to a negative pressure airborne infectious isolation room.

The negative pressure conversion duct connection kit is designed for easy setup by non-HVAC personal typically on duty at a hospital, with little or no modification to the existing HVAC system.

Legend

- A — 8-inch diameter flexible duct hose, 72-inch length
- B — Hose clamp
- C — Register connection
- D — Lag bolts

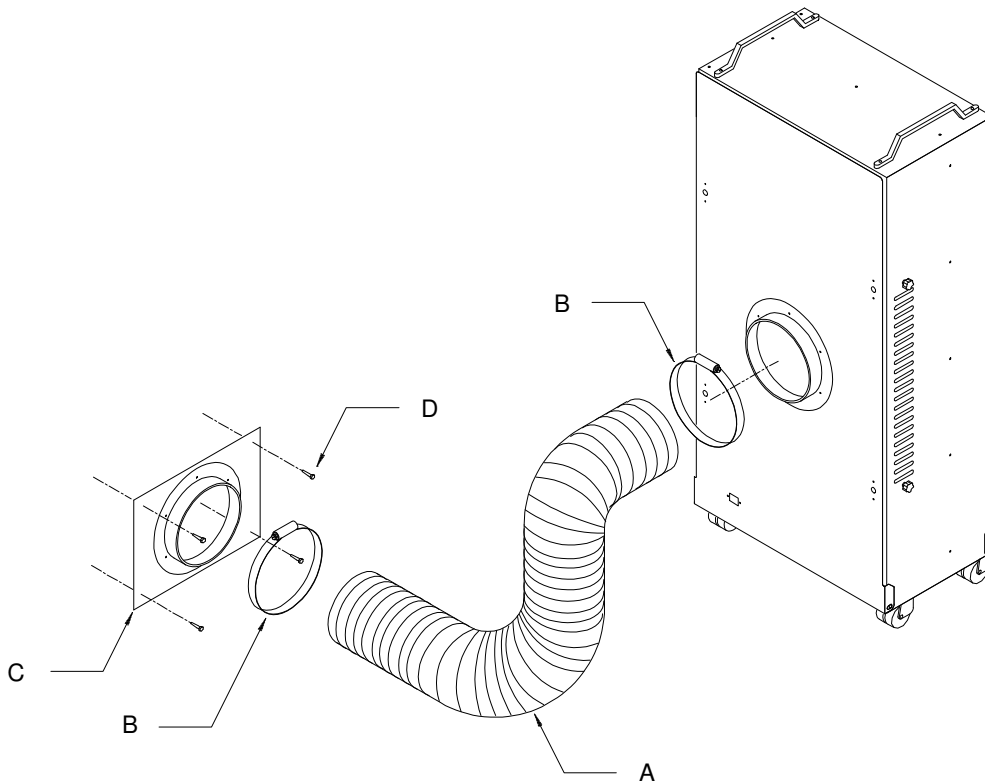

Permanent ceiling installation

The optional ceiling hanger kit allows for a permanent and economical conversion of a standard patient room to an infectious isolation room in accordance with OSHA and CDC guidelines and recommendations.

Legend

- A — Dropped ceiling
- B — Building cross member
- C — Attachment screw
- D — Ceiling bracket kit
- E — Jam nut
- F — Threaded rod
- G — Angle bracket

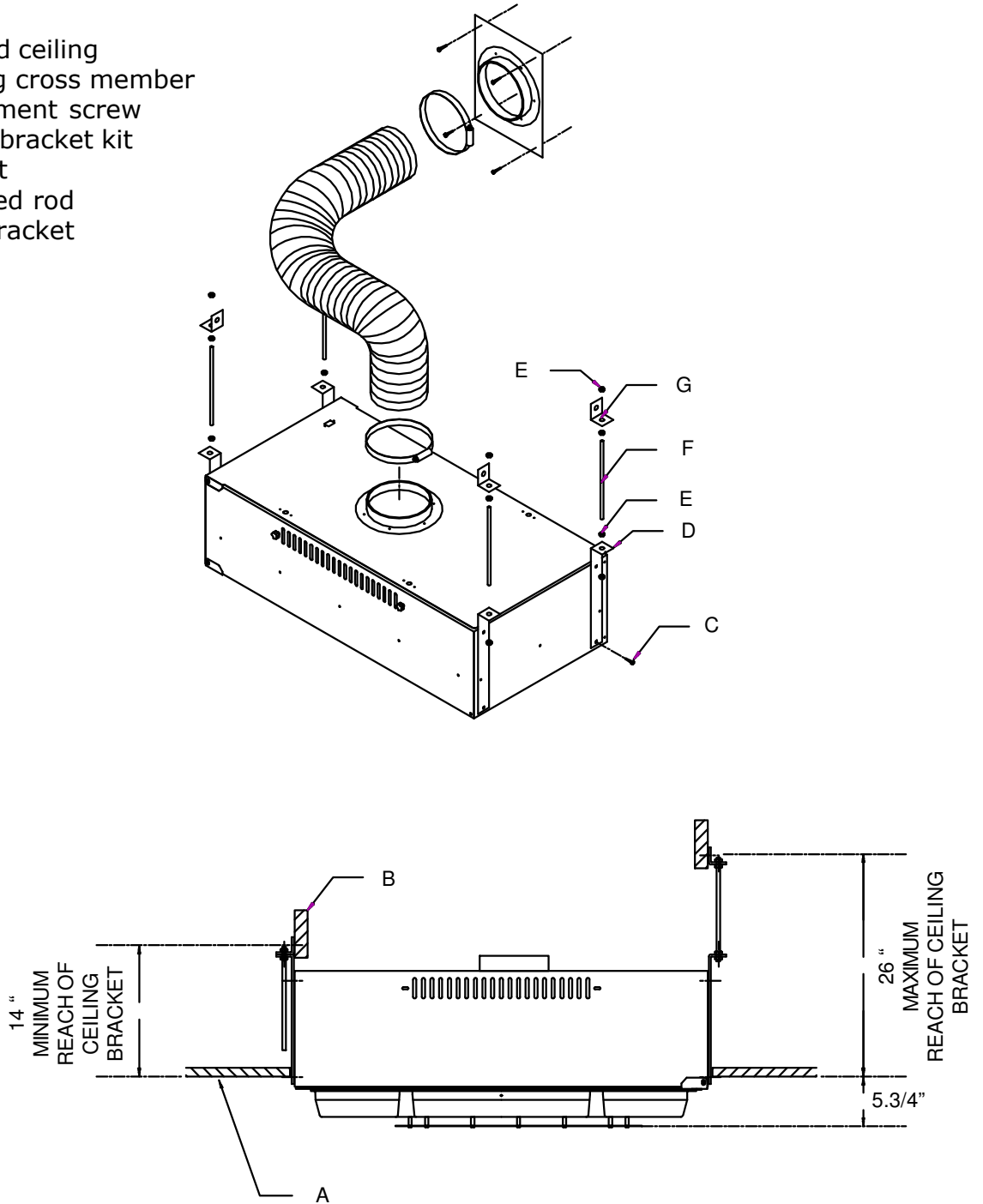

Changing the pre-filter and UV lamps

The front loading filter door allows for easy changing of the negative pressure pre-filter and UV-C lamps when the unit is either on portable casters or permanently mounted in the ceiling.

Legend

- A — Hand knob (4 total)
- B — Negative pressure pre-filter
- C — UV lamps

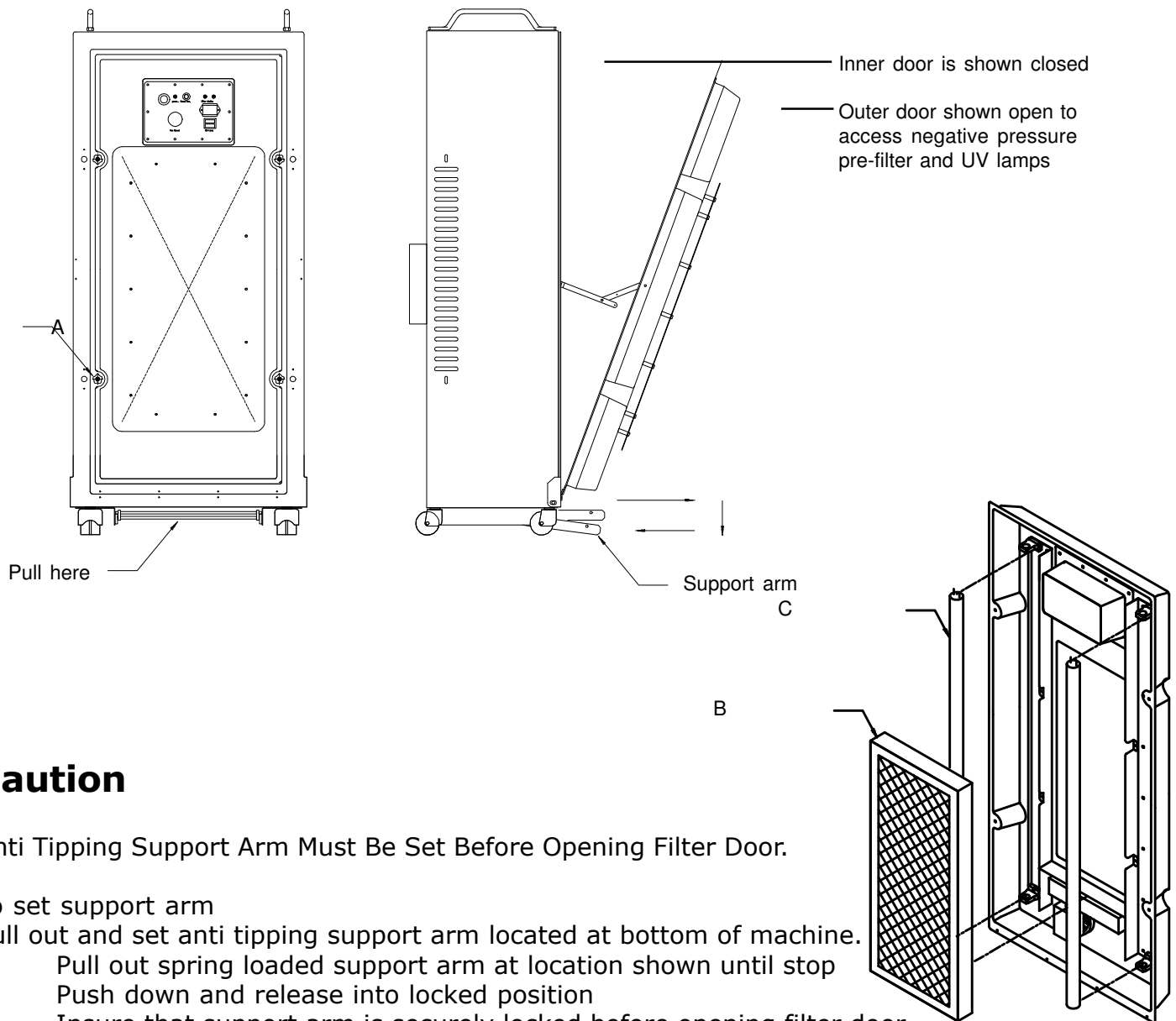

Caution

Anti Tipping Support Arm Must Be Set Before Opening Filter Door.

To set support arm

Pull out and set anti tipping support arm located at bottom of machine.

1. Pull out spring loaded support arm at location shown until stop
2. Push down and release into locked position
3. Insure that support arm is securely locked before opening filter door.

To release arm

1. pull arm forward free of lock lift and release.

Changing the HEPA filter

The front loading filter door allows for easy change out of the HEPA filter when the unit is either on portable casters or permanently mounted in the ceiling .

Legend

- A — Slotted head quarter turn lock
- B — HEPA
- C — Positive pressure pre-filter

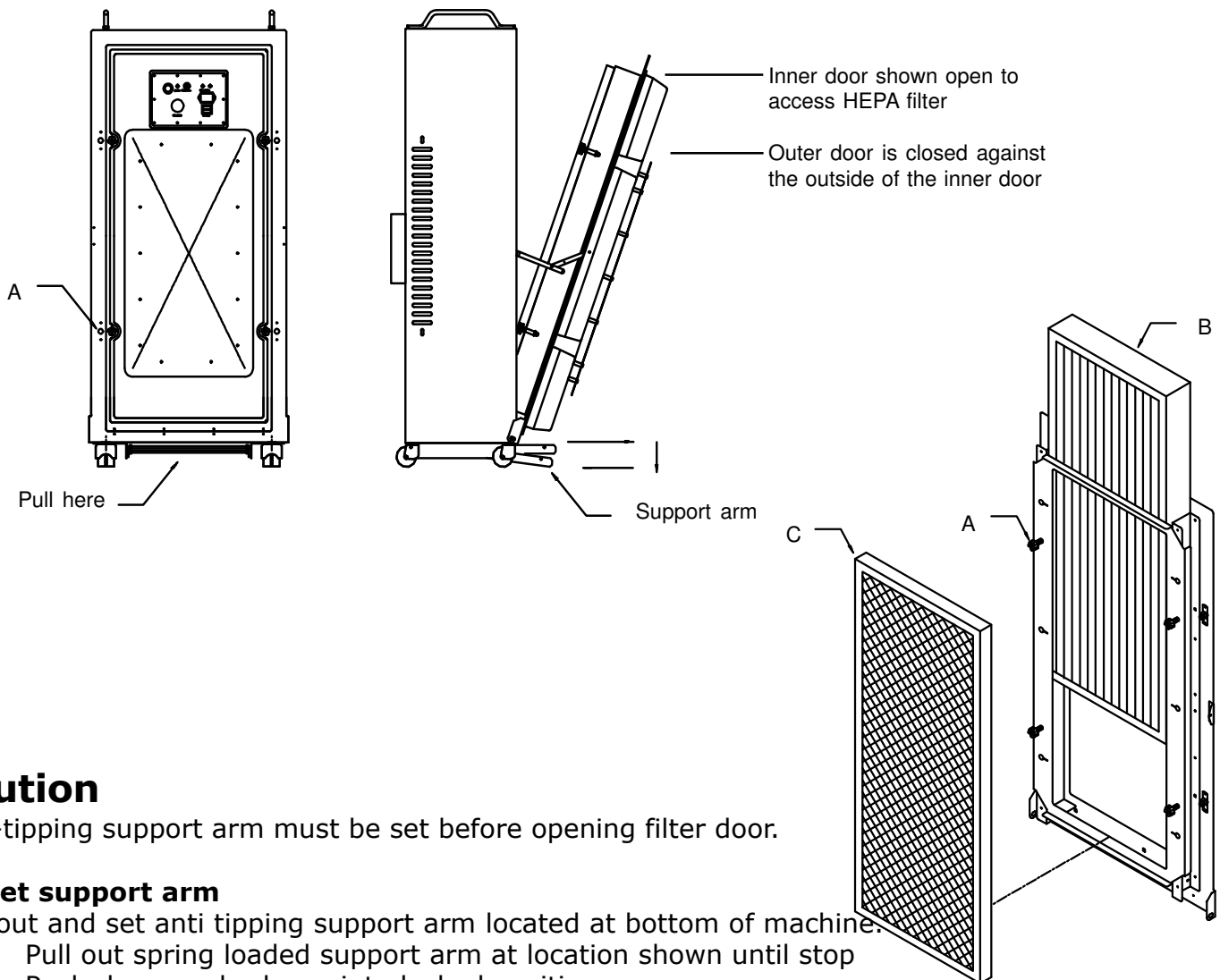

Caution

Anti-tipping support arm must be set before opening filter door.

To set support arm

Pull out and set anti tipping support arm located at bottom of machine.

1. Pull out spring loaded support arm at location shown until stop
2. Push down and release into locked position
3. Insure that support arm is securely locked before opening filter door.

To release arm

1. pull arm forward free of lock lift and release.